



HUAWEI
ALE-L21C432B550
Software Upgrade Guideline

Prepared by	CMO	Date	2015-12-4
Reviewed by	CMO	Date	2015-12-4
Approved by	CMO	Date	2015-12-4



Huawei Technologies Co., Ltd.

All rights reserved



Contents

CONTENTS.....	2
1 VERSION INTRODUCTION.....	3
1.1 THE FOLLOWING VERSIONS CAN BE UPGRADED.....	3
1.2 UPGRADE PACKAGE.....	3
2 UPGRADE ENVIRONMENT REQUIREMENTS.....	3
2.1 CHECK CURRENT UPGRADE ENVIRONMENT.....	3
3 UPGRADE INTRODUCTION.....	4
4 UPGRADE OPERATIONS.....	4
4.1 NORMAL UPGRADE.....	4
4.2 FORCE UPGRADE.....	5
4.3 VENDOR PACKAGE UPGRADE.....	6
5 UPGRADE VALIDATE.....	8
5.1 CHECK THE VERSION.....	8



1 Version introduction

1.1 The following versions can be upgraded.

Versions can be upgraded
ALE-L21C432B524
ALE-L21C432B194
ALE-L21C432B188
ALE-L21C432B170
ALE-L21C432B010

1.2 Upgrade package

Upgrade package	Info
Main package	\\dload\UPDATE.APP
Upgrade tools	Micro SD card

2 Upgrade environment requirements

2.1 Check current upgrade environment

1) To make sure that the Micro SD card is available and can be read and write.

Notes: A Micro SD card of 8GB or more should be available. It is recommended that The Micro SD card is made by Sandisk, Kingstone, or Kingmax .

2) To make sure that the power of the battery is enough to run the upgrade process. It is recommended that the power of the battery is more than 30%.

3) Upgrade operations will erase all user data. So if there is some important information, you should backup them before upgrade.

4) If the path of main package is a .zip file in chapter 1.2, you should unzip the .zip file firstly, and get out UPDATE.APP to do upgrade operation.



3 Upgrade introduction

There are two methods to upgrade: normal upgrade and force upgrade.

Normal upgrade needs to start the handset and enter the System Update module. Force upgrade is just used when the handset can't boot up or can't enter the idle screen.

4 Upgrade operations

4.1 Normal upgrade

Step 1. Format the Micro SD card (This operation is optional).

Step 2. Copy the Software: main package UPDATE.APP to a directory named dload.

Step 3. Copy the entire dload folder (with UPDATE.APP in it) to the root directory of the Micro SD card. Check if the whole file list in sdcard,

Insert the Micro SD card into the handset and power on. After entering call ->

enter:***#2846579#*** -> ProjectMenu -> Software Upgrade -> SDCard Upgrade->

OK.

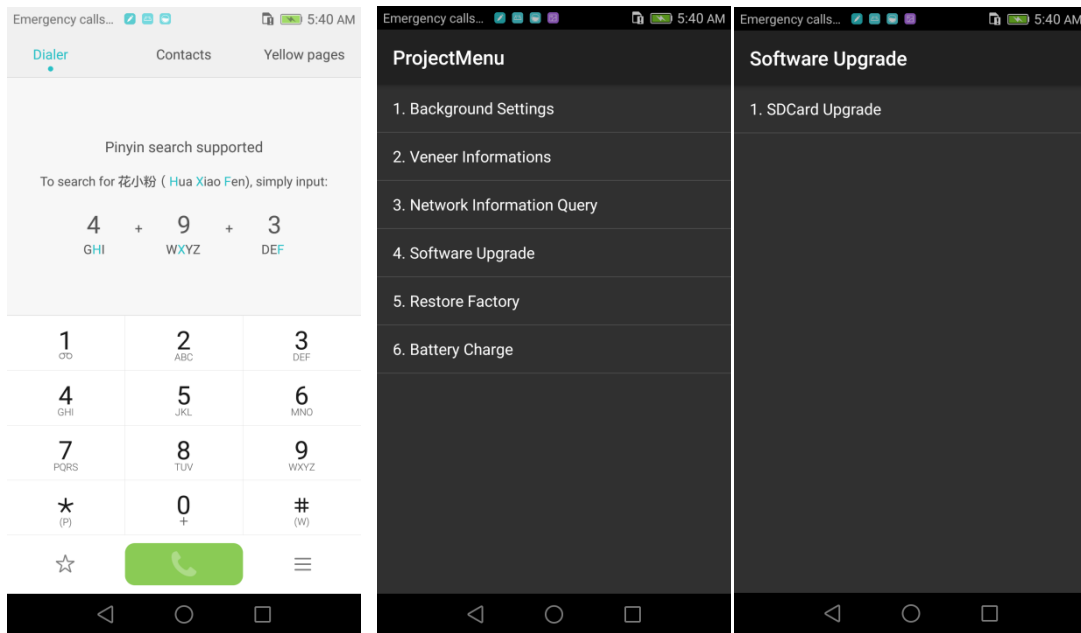

Step 4. When the progress bar stop, the phone will restart automatically.

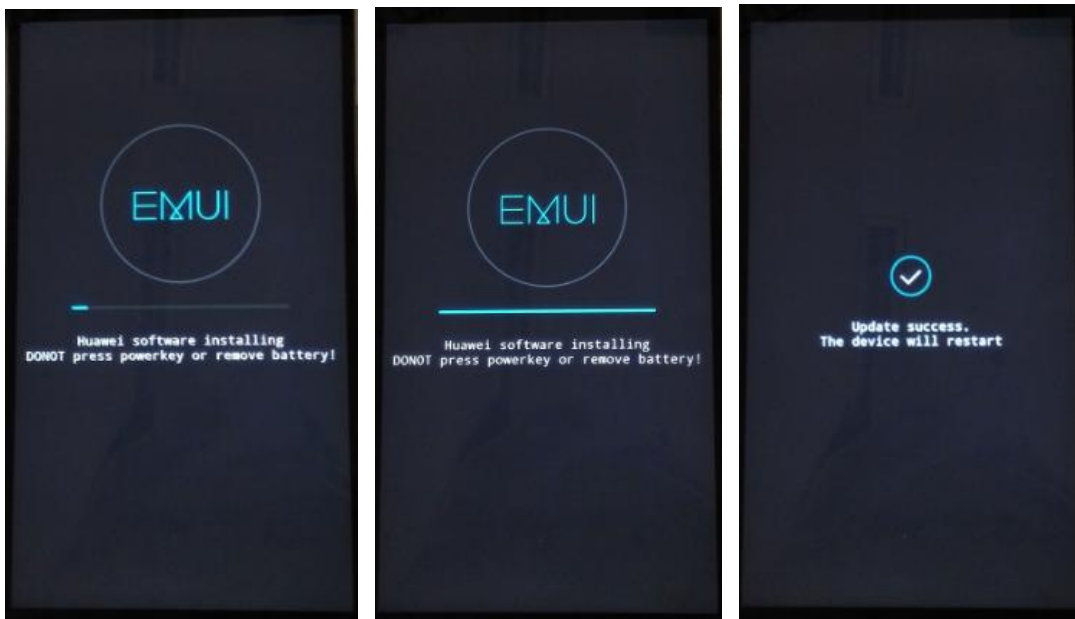

4.2 Force upgrade

Step 1. Format the Micro SD card (This operation is optional).

Step 2. Copy the **Software: main package** to a directory named **dload**.



Step 3. Copy the entire dload folder (with **UPDATE.APP** in it) to the root directory of the Micro SD card. Check the file list is right.

Step 4. Make sure your handset is **power off**. Insert the Micro SD card into the handset. Press the **VOLUME UP** and **VOLUME DOWN** key, and then press the **POWER** key to power on the phone and enter the Software Upgrade Mode.

Step 5. When the progress bar stop, the phone will restart automatically.

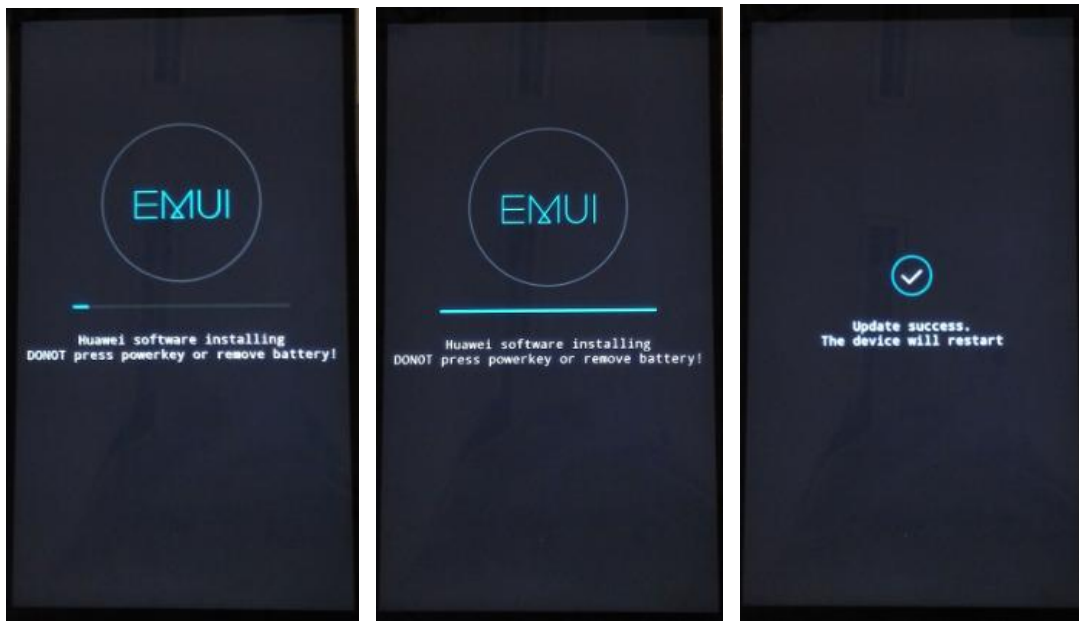

4.3 Vendor package upgrade

Step 1. Format the Micro SD card (This operation is optional).

Step 2. Copy the entire dload folder (with Vendor package **UPDATE.APP** in it) to the root directory of the Micro SD card. Check if the whole file list in sdcard,

Insert the Micro SD card into the handset and power on. After entering call ->

enter:***2846579*** -> ProjectMenu -> Software Upgrade -> SDCard Upgrade->

OK

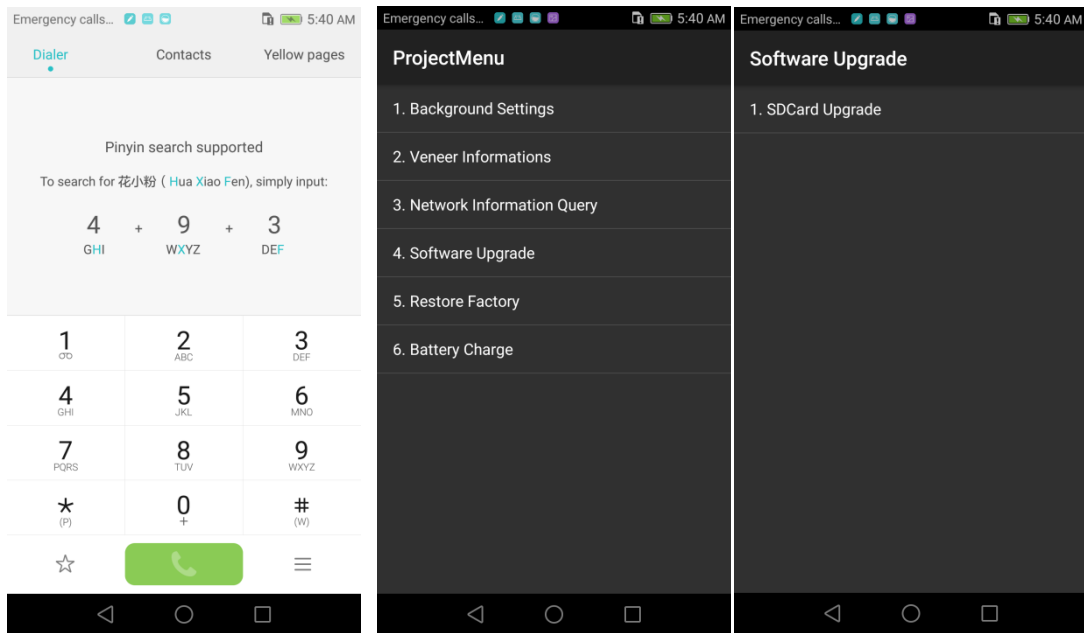

Step 3. When the progress bar stop, the phone will restart automatically.

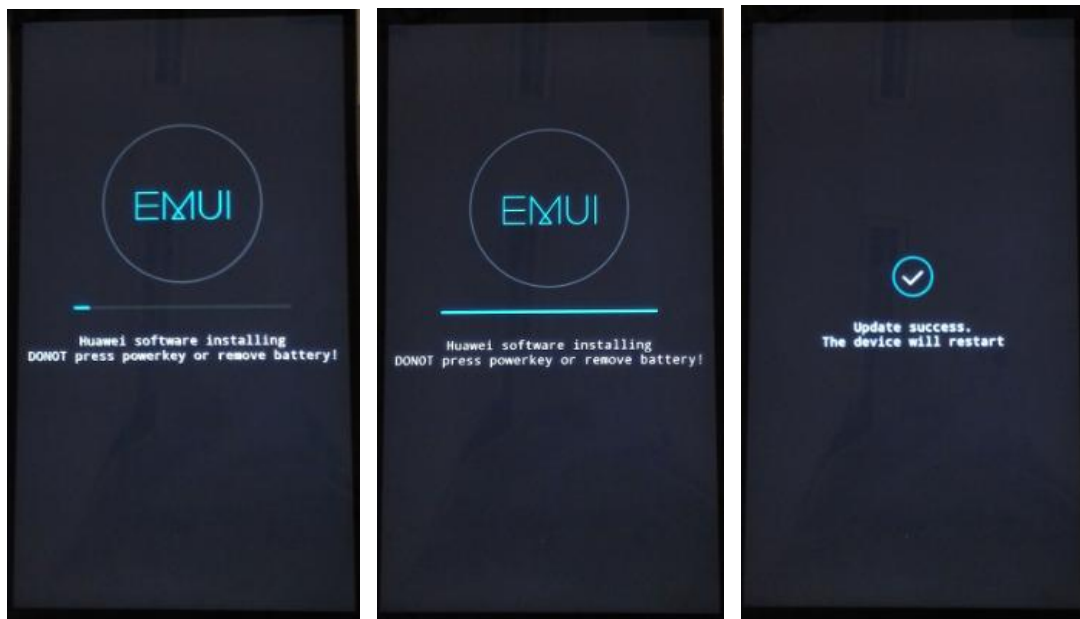

Step 4. After vendor package upgrade successfully, you must **manually restore factory settings**.

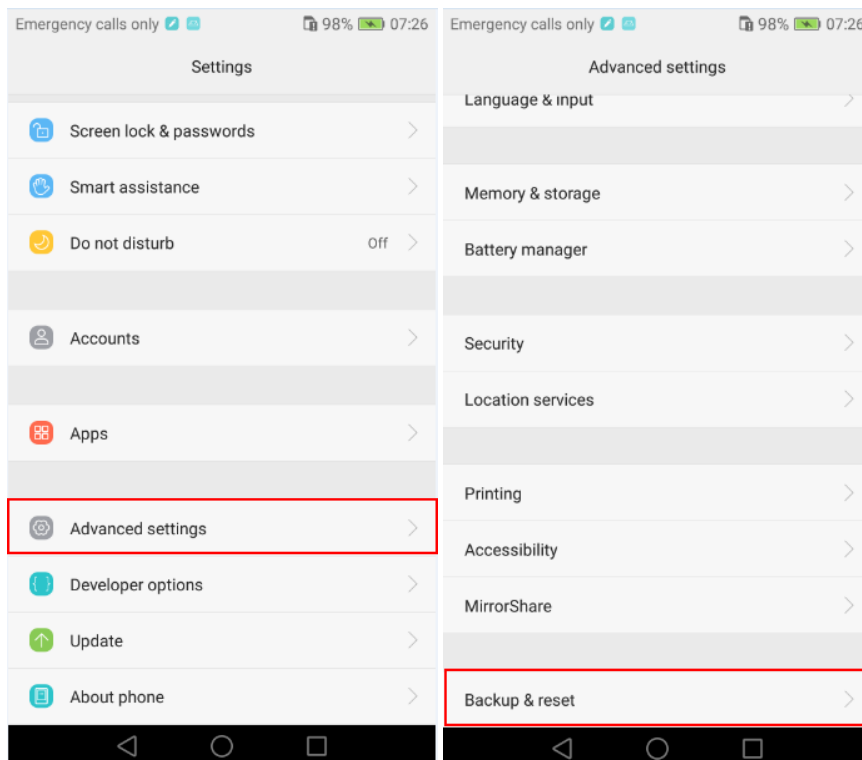

5 Upgrade validate

5.1 Check the version

1. By step: **Settings->About phone->Build number**, to check the version is correct or not.



The build number is ALE-L21C432B550